

# Large Format / Engineering Documents

*Document Solutions that Drive Productivity  
Today and Tomorrow.*

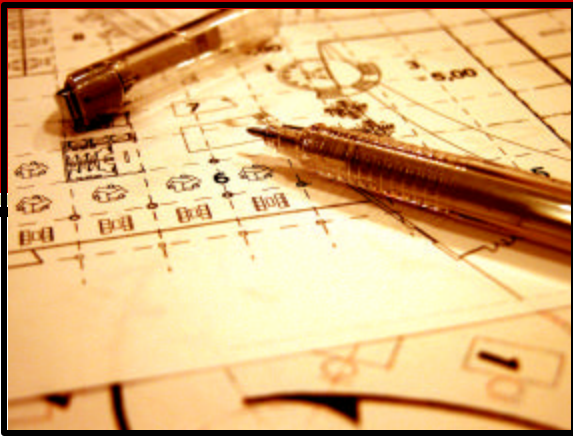

**STREAMLINE** your engineering  
document *workflow* process.

**SHORTEN** your product  
*development* cycles.

**SPEED** up your  
*time to market.*

Today, deadline pressures are one of the biggest problems that engineers face in their jobs. Time to market is getting shorter, leading to increased demands on staff. According to a recent survey of design engineers, 81 percent are being asked to design products in less time than just a year ago – and nearly half have fewer people available to do the work.

On top of everything else, increasing competitive pressures are forcing organizations to focus on efficient, quality delivery from every resource within an organization.

Comsquared's UNI Search® document imaging and workflow system provides an important link between document scanning, indexing and archiving; and the job assembly, repeatable documents distribution and tracking.

Show	Keyed	Column Name	Lower	Upper
<input checked="" type="checkbox"/>		PROJECT NAME	<input type="text"/>	<input type="text"/>
<input checked="" type="checkbox"/>		ALIAS NAME	<input type="text"/>	<input type="text"/>
<input checked="" type="checkbox"/>		ENGINEER	<input type="text"/>	<input type="text"/>
<input checked="" type="checkbox"/>		MAP#	<input type="text"/>	<input type="text"/>
<input checked="" type="checkbox"/>		DOC TYPE	<input type="text"/>	<input type="text"/>
<input checked="" type="checkbox"/>		DOC DATE	<input type="text"/> / <input type="text"/> / <input type="text"/>	<input type="text"/> / <input type="text"/> / <input type="text"/>
<input checked="" type="checkbox"/>		LOCATION	<input type="text"/>	<input type="text"/>
<input checked="" type="checkbox"/>		NOTEPAD	<input type="text"/>	<input type="text"/>

Figure 1: UNISearch/XL Index Screen.

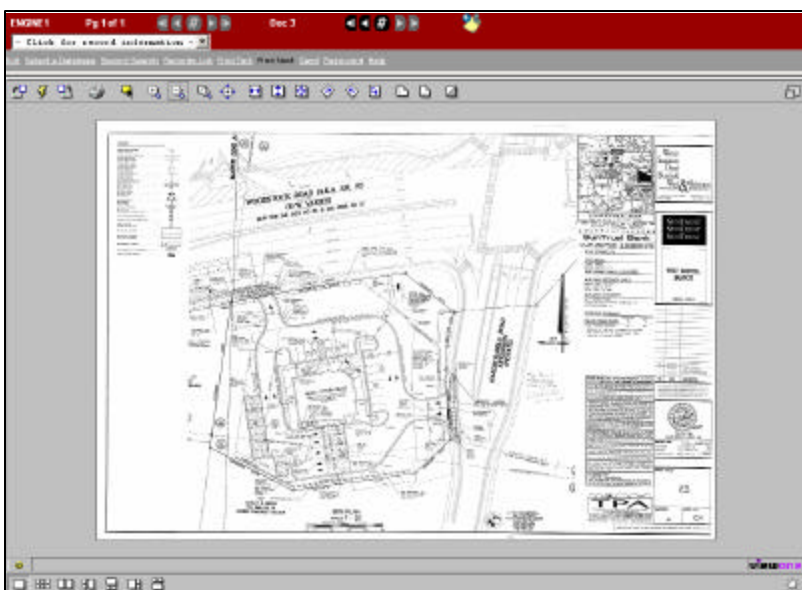

Figure 2: View of full-sized drawing, captured using an engineering plotter/scanner.

- **Lowering Processing Costs** – Image-based processes typically cost 30% less than the same paper-based processes. Electronic solutions provide network access to documents; eliminating copying, faxing, mailing, filing and storage costs.
- **Leveraging Existing Technology Investments** – Comsquared's commitment to open standards ensures effortless integration with existing databases, accounting, billing and engineering software packages.
- **Improve regulatory compliance and emergency response capabilities** – Comsquared's products are designed to allow you to retrieve any documents within seconds, should the need arise due to litigations or EPA inquiries as well as others. Security, protection and audit-trail proof is at the foundation of all Comsquared's solutions.

## UNISearch® Features

- Allows you to automatically capture, store, distribute and access files over your LAN, WAN or the Internet
- Seamlessly Integrates with most core business applications.
- Both Windows and Browser clients available, important documents can be displayed instantly at your workstation.
- Print Visible feature allows you to print only a specified section of the full document.
- Mark-up annotation's are saved separately, so the original files remain intact.
- Remote Facilities Management from our support center eliminates the need for on-site technical support staff to manage any server functions. One call to our 800 support center resolves any software or hardware questions that may arise. We support your entire system!

Comsquared Systems is committed to helping our clients solve their business issues by creatively applying technology.

Comsquared has a long history of leadership and innovation with Utilities, Manufacturing, Architecture, Engineering & Construction (AEC) marketplaces.

**Market segments that utilize UNISearch to optimize and streamline the full range of operations, include:**

- Manufacturing
- Engineering
- Construction
- Architectural
- Commercial Reprographics
- Business Services
- Government
- Utilities
- Energy

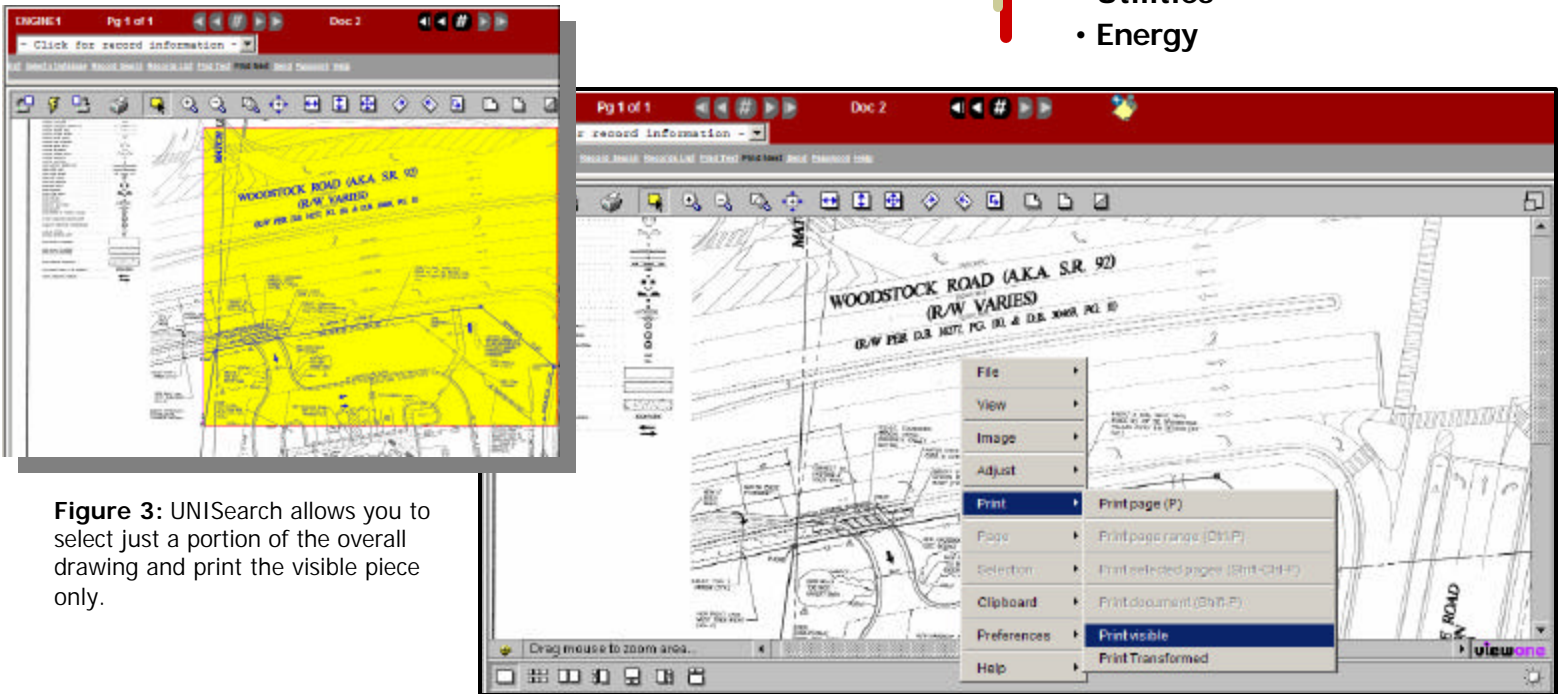

**Figure 3:** UNISearch allows you to select just a portion of the overall drawing and print the visible piece only.

### About Comsquared Systems

Comsquared Systems, headquartered in Atlanta, GA, is a leading provider of document workflow and imaging solutions for Enterprise Content Management (ECM) and business process automation. With more than 25 years of industry experience, our UNISearch®, ImageDirector™, and YourSecurePoint® family of content software solutions help organizations transform unmanageable paper-based processes into efficient, easy-to-use electronic solutions, providing companies with the ability to manage content, streamline processes, and drive a significant return on investment.

# COMSQUARED

S Y S T E M S

5125 Peachtree Industrial Blvd. ▪ Norcross, GA 30092  
1.800.592.3766 ▪ info@comsquared.com  
www.comsquared.com